

# WILSON ELECTRONICS ADAPTER GUIDE

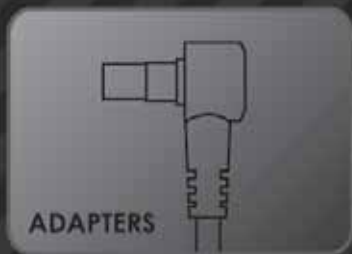

- Reduce Dropped Calls
- Improve Voice and Data Quality
- Easy to Install

**Wilson Adapters Provide the Highest Quality and Performance.**

If your phone or data card is not listed, please ask your dealer, or call Wilson Electronics 1-866-294-1660.

Visit [www.wilsonelectronics.com](http://www.wilsonelectronics.com) for the latest updates to our wide range of adapters.

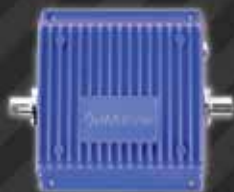

**Issue 10**

*Improving Your Cellular Signal*

Model#	Wilson Adapter #	Port Position
<b>AUDIOVOX / UTSTARCOM</b>		
<b>CELLULAR DATA CARDS</b>		
PC3220	359917	End
PC3320	359912	End
PC5220	359917	End
PC5740	None*	No Port
PC5750	359919	Side Port
<b>PHONES</b>		
200, 219, 250	359906	Back Plug
300 Series	359906	Back Plug
400	359906	Back Plug
888	359906	Back Plug
989	359906	Back Plug
BAM 330	356801	Bottom Plug
CDM 100	359910	Back Plug
CDM 105	359920	Back Plug
CDM 130, 135 Series	359908	Back Plug
CDM 150	359920	Back Plug
CDM 180	359909	Back Plug
CDM 2500 Series	359905 / 359915	Side Plug
CDM 7000	359920	Back Plug
CDM 8100	359908	Back Plug
CDM 8150	359910	Back Plug
CDM 8200, 8300 Series	359905 / 359915	Side Plug
CDM 8410, 8450	Not Available	866.294.1660
CDM 8500	359905 / 359915	Top Plug
CDM 8600 Series	Not Available	866.294.1660
CDM 8900 Series	Not Available	866.294.1660
CDM 8915	359909	Back Plug
CDM 9000	Discontinued	Back Plug
CDM 9900	Not Available	866.294.1660
G'z One Type V	359919	Back Plug
PCX 1110	359908	Back Plug
PPC-6700	359909	Back Plug
T300	359910	Back Plug
VI600	Not Available	866.294.1660
XV6700	359909	Back Plug
<b>CINGULAR</b>		
2100, 2125 (Faraday)	359909	Back Plug
3125	Call Tech Support	866.294.1660
8100, 8125 (MDA, K-JAM)	359909	Back Plug
S621	359909	Back Plug (under mirror)
<b>CURITEL</b>		
Identity	359909	Back Plug
<b>DELL WIRELESS</b>		
5700	359918	Top Plug
<b>DENSO</b>		
1100	359907	Back Plug
2200	359907	Back Plug
<b>FRANKLIN WIRELESS</b>		
CDU-550 USB AirCard	None*	No Port

Model#	Wilson Adapter #	Port Position
<b>HANDSPRING / PALMONE</b>		
Treo 600	358501	Back Plug
Treo 650	358502	Back Plug
Treo 680	358504	Back Plug
Treo 700p	358503	Back Plug
Treo 700w, 700wx	358502	Back Plug
Treo 750	358505	Back Plug
<b>HITACHI</b>		
SH-P300	359908	Back Plug
<b>HP</b>		
h6315 / h6310	355501	Back Plug
<b>HTC</b>		
2100, 2125 (Faraday)	359909	Back Plug
3125	Call Tech Support	866.294.1660
8100, 8125 (MDA, K-JAM)	359909	Back Plug
S620 (Dash, Excalibur)	359909	Back Plug
S621	359909	Back Plug (under mirror)
<b>KYOCERA / QUALCOMM</b>		
<b>CELLULAR DATA CARDS</b>		
KPC 650	357014	End Plug
<b>PHONES</b>		
1135	357008	Back Plug
2119, 2135	357006	Back Plug
2235	357008	Back Plug
2325	357008	Back Plug
3225	357009	Back Plug
3245	357010	Back Plug
3250	357010	Back Plug
5135	359913	Top Ring w / Plug
6035 Smart Phone	357004	Back Plug
7135	None*	No Port
K7, K9	357009	Back Plug
K404, K480, K483	357009	Back Plug
K484 (Aktiv)	357009	Back Plug
K494 (Energi)	357009	Back Plug
K4130 (SoHo)	357012	Back Plug
K612 (Strobe)	None*	No Port
KE413, KE414, KX414 (Phantom Series)	357009	Back Plug
KE424(c), KX424 (Blade Series)	357009	Back Plug
KE433, KX433, KX434 (Rave Series)	357009	Back Plug
Kx1 (SoHo)	357012	Back Plug
Kx2 (Koi)	357013	Back Plug
Kx5 (Remix)	Not Available	866.294.1660
Kx9b(c) (Milan)	357015	Back Plug
Kx16 (Candid)	357015	Back Plug
KX 160	None*	No Usable Port
KX 440, 444	357009	Back Plug
Q PHONE	357001	Bottom Plug
QCP thin 860, 1960, 2760	None*	No Port
SE44, SE47 (Slider)	Not Available	866.294.1660

\*Recommended for use with wireless amplifiers.

Model#	Wilson Adapter #	Port Position
<b>LG</b>		
4NE1	359910	Back Plug
110 Series	359907	Back Plug
245	359919	Back Plug
330	356801	Top Screw
510, 520 Series	359907	Back Plug
1010	359913	Top Ring w / Plug
1200	359913	Top Ring w / Plug
3100	359913	Top Ring w / Plug
3450	359919	Back Plug
4750	359919	Back Plug
6070	359920	Back Plug
6190	359909	Back Plug
6200	356808	Side Plug
9100	359919	Under Battery Cover
AX245	359919	Back Plug
AX355, UX355	359919	Back Plug
AX390, AX490	359919	Back Plug
AX4270	359919	Under Battery Cover
AX4650, AX4750	359919	Back Plug
AX5000	356808	Side Plug
C1300, C1500	359919	Back Plug
C2000	359919	Back Plug
CE500	359919	Back Plug
CG225	359919	Back Plug
CG300	356808	Side Plug
CU320, CU400, CU500	359919	Back Plug
F7200, F9100	359919	Under Battery Cover
G4010, G4011	356804	Top Plug
G4015, G4020	359919	Back Plug
L1100, L1150	359919	Back Plug
L1200, L1400	359919	Back Plug
LX350	359919	Back Plug
LX550 FUSIC	359919	Back Plug
LX5350, LX5450	Not Available	866.294.1660
LX5550	356805	Back Plug
MM535	359909	Back Plug
PM225	356808	Side Plug
PM325	None*	No Port
TM250	359913	Top Plug
UX210	359919	Back Plug
UX390	359919	Back Plug
UX4750	359919	Back Plug
UX5000	356808	Side Plug
V111	359907	Back Plug
V1125, V15225	Not Available	866.294.1660
VX1, VX10	359907	Back Plug
VX2000	359910	Back Plug
VX3100	359913	Top Ring w / Plug
VX3200	359909	Back Plug
VX3280	359919	Back Plug

Model#	Wilson Adapter #	Port Position
VX3300	359919	Under Battery Cover
VX3400	359919	Back Plug
VX4400, VX4500	359910	Back Plug
VX4600	359909	Back Plug
VX4650	359919	Back Plug
VX4700	359919	Back Plug
VX5200	356808	Side Plug
VX5300	359919	Back Plug
VX6000, VX6100	359909	Back Plug
VX7000	359909	Back Plug
VX8000, VX8100	359909	Back Plug
VX8300	359919	Back Plug
VX8500 (Chocolate)	359919	Back Plug
VX8600	359921	Back Plug
VX8700	None*	No Port
VX9800	359909	Back Plug
VX9900 (enV)	359919	Back Plug
<b>MERLIN (NOVATEL) Wireless PC Card</b>		
C201	None*	No Port
EX720	359918	Side
G100	359916	End
G301	359912	Side
G2000	359916	End
S620, S720	359918	Side
U630, U730	359918	Side
U720 USB AirCard	359909	Top Plug
USB720	359909	Top Plug
V620, V640, V740	359918	Side
<b>MITSUBISHI</b>		
G75	359905 / 359915	Back Plug
G340	359905 / 359915	Back Plug
T200, T250	359905 / 359915	Back Plug
T300 (must use included Velcro)	359910	Back Plug
<b>MOTOROLA</b>		
120 Series (c,e,t,x)	352013	Back Plug
A630	359909	Back Plug
C139	None*	No Usable Port
C155, C290	359909	Back Plug
C331, C332, C333, C341, C343, C353	Call Tech Support	866.294.1660
E1 ROKR	359909	Back Plug
E310	359909	Back Plug
E815, E816	Not Available	866.294.1660
ic502	None*	No Port
KRZR K1m	None*	No Usable Port
Microtac 650	352009	Top Replacement Antenna
Microtac Lite XL	352009	Top Replacement Antenna
MPX 200	None*	No Port
MPX 220	352016	Back Plug
Profile 300 Series	352009	Top Replacement Antenna
Q	None*	No Port

\*Recommended for use with wireless amplifiers.

Model#	Wilson Adapter #	Port Position
R1ZR Z3	Not Available	866.294.1660
SC3160	None*	No Port
T193	352013 / 359909	Back Plug
T300P	Call Tech Support	866.294.1660
T720, T721, T722	359909	Back Plug
T730, T731	359909	Back Plug
T2000 Series	352006	Back Plug with Top Replacement Antenna
T7000 Series	402005	RF Charger
T8000 Series (8090, 8097, 8160, 8167, 8767)	402005	RF Charger
Ultima Series	359909	Back Plug
V3 RAZR Series (except V3m and V3x)	352015	Back Plug
V3m and V3x RAZR	Call Tech Support	866.294.1660
V3 Maxx (ve)	None*	No Port
V3r	352015	Back Plug
V3xx RAZR	352015	Back Plug
V60i, V60c	352007	Back Plug
V60p, V60s, V60x	352014	Back Plug
V65p	Not Available	866.294.1660
V66	352012	Back Plug
V80	None*	No Port
V120 Series (c.e.t.x)	352013	Back Plug
V170, V171, V173	359909	Back Plug
V180, V186, V188	None*	No Usable Port
V190	None*	No Usable Port
V200 Series	359910	Back Plug
V220	None*	No Usable Port
V235	359920	Back Plug
V260, V262, V265, V266	359909	Back Plug
V276	359909	Back Plug
V300	359909	Back Plug
V323, V325	359909	Under Battery Cover
V330	359909	Back Plug
V360	None*	No Port
V400	359909	Back Plug
V500 Series	359909	Back Plug
V600	359909	Back Plug
V710, V810	359909	Back Plug
V2000 Series	352006	Back Plug with Top Replacement Antenna
V3620, V3682	402005	RF Charger
V8160, V8162	402005	RF Charger
W315	352018	Under Battery Cover
W385	352018	Back Plug
X507	None*	No Port
<b>NEC</b>		
525	359902	Side Plug
<b>NEXTEL / SOUTHERN LINC / MIKE</b>		
<b>CELLULAR DATA CARDS</b>		
im 200, im240 PC Card	354011	Antenna Replacement
<b>PHONES</b>		

Model#	Wilson Adapter #	Port Position
i30, i35	354006	Back Plug
i50, i55, i58	354004	Back Replacement
i60	354005	Back Plug
i85, i88	354004	Back Replacement
i90, i95	354005	Back Plug
i205	354009	Back Replacement
i215	354010	Back Plug
i265	354010	Back Plug
i275	354010	Back Plug
i285	None*	No Port
i305, i315, i325, i355	354008	Back Plug
i370 (except i370R)	354001	Ring
i390	354001	Ring
i500	354001	Ring
i530, i533	354007	Top Plug w/ Antenna Replacement
i550 plus	354001	Ring
i600	354001	Ring
i605	Not Available	866.294.1660
i670	None*	No Port
i700 plus	354001	Ring
i710, i720	354007	Top Plug w/ Antenna Replacement
i730, i733, i736	354007	Top Plug w/ Antenna Replacement
i740	354007	Top Plug w/ Antenna Replacement
i800 Series	None*	No Port
i1000, i1000 plus	354002	Ring
i2000 plus	354001	Ring
<b>NOKIA</b>		
232	359904	Bottom Plug
252, 282	359903	Ring
1100	None*	No Port
1221	None*	No Port
1260	None*	No Port
1261	None*	No Port
2100 Series (except 2170, 2125i, 2126i, 2128i)	359904	Bottom Plug
2125i, 2126i, 2128i	None*	No Port
2260	None*	No Port
3120(B)	None*	No Port
3220	None*	No Port
3285	359907	Back Plug
3300 Series (3360, 3390, 3395)	None*	No Port
3516i	None*	No Port
3560, 3570	None*	No Port
3585 Series	None*	No Port
3586i, 3588i, 3589i	None*	No Port
3590, 3595	None*	No Port
3600, 3620, 3650	None*	No Port
5100	No Port	Back Plug
6010	None*	No Port
6015i, 6016i, 6019i	None*	No Port
6100	None*	No Port

\*Recommended for use with wireless amplifiers.

Model#	Wilson Adapter #	Port Position
6215i	359919	Back Plug
6255i, 6256i	None*	No Port
6300 Series (except 6305i, 6315i)	359907	Back Plug
6305i, 6315i	359919	Back Plug
6590 Series	None*	No Port
6610(i)	None*	No Port
6800	None*	No Port
7100	359907 / 353001	Back Plug
7210	None*	No Port
8265	353007	Back Plug
8270	None*	No Port
8290	None*	No Port
8390	None*	No Port
8890	None*	No Port
S621	359909	Back Plug (under mirror)
<b>OPTION</b>		
GT-Max	359917	Side Plug
GT-Max (with Wi-Fi)	None*	866.294.1660
<b>PALMONE please see HANDSPRING</b>		
<b>PANTECH</b>		
<b>CELLULAR DATA CARDS</b>		
PX-500	359919	Side Port
<b>CELLULAR PHONES</b>		
PG-C300	359919	Back Plug
PN-205, PN-210	359919	Back Plug
PN-212, PN-215	359909	Back Plug
PN-218	359909	Back Plug
PN-300	359909	Back Plug
<b>SAMSUNG</b>		
210	None*	No Port
411	358001	Bottom Plug
811	None*	No Port
850	359905 / 359915	Top Plug
1000	None*	No Port
2000	None*	No Port
2010	None*	No Port
6100	359903	Ring
8500	359905 / 359915	Top Plug
A310	359909	Back Plug
A400	359905 / 359915	Top Plug
A460	359910	Back Plug
A500, A530, A540	359909	Back Plug
A560	None*	No Port
A570	359909	Back Plug
A580	None*	No Port
A600	359909	Back Plug
A610	359910	Back Plug
A620 (VGA-1000)	359909	Back Plug
A640, A645	None*	No Port
A650	359909	Back Plug
A660 (VI-660)	359909	Back Plug

Model#	Wilson Adapter #	Port Position
A670	359909	Back Plug
A680 (VM-A680)	359909	Back Plug
A700	359909	Back Plug
A707	359921	Under Battery Cover
A717	359921	Under Back Plate
A727	359921	Back Plug
A740	359909	Back Plug
A760	359909	Back Plug
A790	359909	Back Plug
A840	None*	No Port
A850	None*	No Port
A870	None*	No Port
A880	None*	866.294.1660
A890	359909	Back Plug
A900	359921	Under Battery Cover
A920	None*	866.294.1660
A930	None*	866.294.1660
A950	None*	866.294.1660
A970	359909	Back Plug
C207	None*	No Port
C417	Weak Port	N/A
D347	None*	No Port
D357	None*	No Port
D407	None*	No Port
D415	359909	Back Plug
D807	359921	Back Plug
E105	359909	Back Plug
E316	None*	No Port
E317	None*	No Port
E335	None*	No Port
E715	358006	Back Plug
i607 Blackjack	359921	Under Back Plate
i700, i730	359909	Back Plug
N150	359910	Back Plug
N200	359905 / 359915	Top Plug
N240	359909	Back Plug
N300	359905 / 359915	Top Plug
N330	359915	Side Plug
N370	359909	Back Plug
N400	359905 / 359915	Side Plug
P107	358006	Back Plug
P207	359919	Back Plug
R225	359910	Back Plug
R510 Wafer	359921	Back Plug
S105	359913	Top Plug
S307	359909	Back Plug
T100	359905 / 359915	Back Plug
T300	359913	Top Plug
T509	359921	Back Plug
T519	359921	Back Plug
T609	None*	No Port

\*Recommended for use with wireless amplifiers.

Model#	Wilson Adapter #	Port Position
U420	359919	Under battery Cover
U540	None*	No Port
U740	359921	Under Battery Cover
X426	359909	Back Plug
X427	359909	Back Plug
X495, X497	None*	No Port
X506, X507	None*	No Port
<b>SANYO</b>		
4500 (except VM4500 / SCP5500)	359908	Back Plug
4700	359908	Back Plug
4900	356501	Back Plug
4920	Not Available	866.294.1660
5150	356503	Back Plug
5300	356504	Back Plug
5400 (RL2500)	356506	Back Plug
5500 (VM4500)	356507	Back Plug
6200	356502	Back Plug
6400	356502	Back Plug
7200 (RL2000)	Call Tech Support	866.294.1660
7300 (RL7300)	356503	Back Plug
8100	356505	Back Plug
8200	356505	Back Plug
MM7400	Not Available	866.294.1660
MM7500	None*	866.294.1660
VI2300	None*	866.294.1660
<b>SHARP</b>		
TM150	359909	Back Plug
<b>SIEMENS</b>		
A56	358603	Back Plug
C56	358603	Back Plug
C61	None*	No Port
M56	358603	Back Plug
S46	358602	Back Plug
S66	358604	Back Plug
SL56	None*	No Port
SX66	359909	Back Plug
<b>SIERRA WIRELESS (Air Card)</b>		
300, 350	359912	End
550, 555	359912	End
580	359917	End
595	359923	Top Plug
750, 775	359912	End
850, 860	359912	End
875	359924	End
PC 3200	359917	End
PC3220	359917	End
PC 3320	359912	End
PC 5220	359917	End
PC 5740	None*	No Port
<b>SONY / ERICSSON</b>		
<b>CELLULAR DATA CARDS</b>		

Model#	Wilson Adapter #	Port Position
GC75 (Vodafone)	355014	Antenna Replacement
GC82, GC83, GC85	355011	Antenna Replacement
GC89	355015	Antenna Replacement
<b>PHONES</b>		
200 Series	355003	Top Plug
300 Series (except DH388)	355003	Top Plug
600 Series (except AH600, AH630)	355001	Back Plug
800 Series	355001	Back Plug
A1228 Series	355005	Top Replacement Antenna
AH 600	355003	Top Plug
AH 630	355003	Top Plug
DH 388	355001	Back Plug
LX700 (if Back Plug is not available)	355003	Top Plug
LX700 (if Back Plug is available)	355001	Back Plug
R250 D, R278 D	355005	Top Replacement Antenna
R280 LX, R289 LX	355005	Top Replacement Antenna
R300 LX	None*	No Port
R320 S	359906	Back Plug
R380 Series	359906	Back Plug
R520 Series	359906	Back Plug
S710a	355013	Back Plug
T28 Series	359906	Back Plug
T62u	355009	Back Plug
T206	355008	Back Plug
T226	None*	No Port
T237	None*	No Port
T290a	None*	No Port
T300, T306	None*	No Port
T610, T616	355010	Back Plug
T637	355010	Back Plug
W600i	355017	Back Plug
W810	355016	Back Plug
Z500 (A)	355012	Back Plug
Z520(a), Z525	None*	No Port
<b>SPRINT / TOUCHPOINT</b>		
CF2031 Aircard	359905	Antenna Replacement
<b>UNIDEN</b>		
PCD 2000A	359905 / 359915	Side Plug

\*Recommended for use with wireless amplifiers.

# Antenna Adapter Type Descriptions



## Back Plug

Plugs into the adapter port on the upper back portion of the phone. A rubber or plastic plug may need to be removed. Press firmly to ensure a good connection - do not twist. Using too much force could damage the phone.



## Top Screw

This antenna adapter replaces the cellular phone's original antenna. Unscrew the original antenna and screw in the antenna adapter. Be sure to save the original antenna - it will be needed after disconnecting the antenna adapter.



## Top Plug

Plugs into the adapter port on the top of the phone. A rubber plug may need to be removed. Press firmly to ensure a good connection - do not twist. Using too much force could damage the phone.



## Side Plug

Plugs into the adapter port on the upper-side of the phone. A rubber plug may need to be removed. Press firmly to ensure a good connection - do not twist. Using too much force could damage the phone.



## Bottom Plug

Plugs into the bottom of the cell phone. Push until you hear a click. Press button(s) in middle or on sides to release connector from phone. Note: an RF charger may be available for the phone - it will allow charging of the phone while using an external antenna.



## Top Ring with Plug

Slides onto the base of the cellular phone's built-in antenna while aligning the plug with the adapter port. Press down firmly to ensure a good connection.



## Cellular Data Cards

Adapter plugs into the adapter ports on the end of the cellular data card or plugs in as an antenna replacement. Check your model for a specific adapter type.



## Back Replacement

Remove the rubber Nextel cover. Remove the 2 screws using the included Torx T8 bit. Attach the new adapter plate using the provided Phillips screws. Tighten left screw then the right. When the adapter is pushed into the back of the phone it should snap into place.



## Ring

Slides onto the base of the cellular phone's built-in antenna. Press down firmly to ensure a good connection. Be sure to lower the phone's built-in antenna.



## Back Plate

Place included Velcro on back top of phone as shown. Attach adapter to Velcro.



## Sleeve

Snaps onto the back of the cellular phone. The sleeve must be mounted to the top of the phone. The sleeve may fit upside down but it will not function properly.

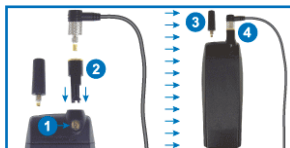

## Top Replacement Antenna

(Figure-1) Pry off plastic cap. Depress plastic tab inside hole while forcefully pulling out the original antenna. (Figure-2) Insert adapter plug into phone with wires facing phone. (Figure-4) Screw adapter into top of phone. (Figure-3) The replacement antenna is needed after disconnecting the adapter.



## Back Plug w/ Top

Replacement Antenna (Figures-1&2) Unscrew the original antenna which is blocking the adapter port. It may have reversed threads. (Figure-3) Screw the included replacement antenna into the top of the phone. The antenna adapter will now fit into the back of the phone - see above for Back Plug instructions.



## TECHNICAL SUPPORT

For additional assistance with your installation:

1) Call Toll-Free at 866-294-1660

2) E-mail tech@wilsonelectronics.com

3) Visit [www.wilsonelectronics.com](http://www.wilsonelectronics.com)

Hours of Operation: 7:00 AM - 6:00 PM (Mountain Time)



**Wilson Electronics Adapter Guide - Issue 10**

3301 East Desert Drive, St. George, Utah 84790

Sales: 866-939-9361

Technical Support: 866-294-1660

[www.wilsonelectronics.com](http://www.wilsonelectronics.com)

© Copyright 2007 • All Rights Reserved